

MACLOC ANCHOR



13.11 PRODUCT DATA

Material Coating:

- Yellow Zinc Plated (Pictured)

13.12 PRODUCT DESCRIPTION

The Macsim Macloc anchor is a 'Traditional' female shell type expansion anchor which gives a flush finish socket and the safety of follow up expansion in the case of over loading. It can be applied in any solid masonry base material that has a comprehensive strength > 15N/mm<sup>2</sup>.

13.14 APPLICATIONS

- Used for Medium Duty Loads
- Solid Masonry

13.13 INSTALLATION METHOD

1. Drill correct diameter and depth of hole in base material. Select correct thread gauge bolt or set screw and ensure total length will not exceed fixture thickness plus maximum engagement depth.
2. Clean the hole and insert the Macloc Anchor ensuring the threaded end is inserted first.
3. Tap in until the top is flush with the surface.
4. Position fixture and insert bolt through unit it properly engages the thread at the base of the Macloc. Use a spanner to tighten the bolt and expand the Macloc. Do not over tighten.

13.15 ADVANTAGES

- 

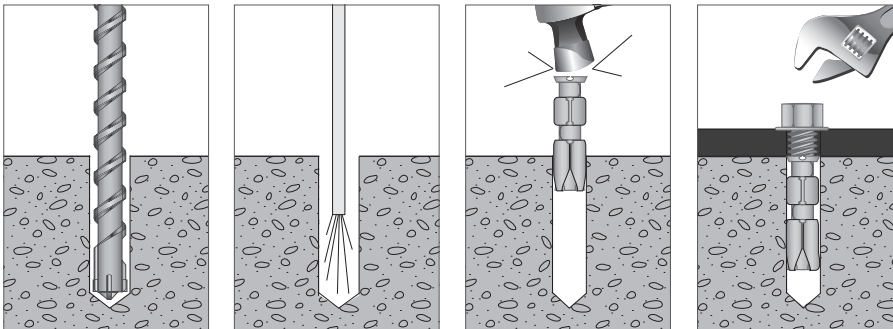

CODE	CODE	Thread Size	Hole Diameter (mm)	Anchor Length (mm)	Minimum Hole Depth (mm)	Max. Screw Engagement (mm)
1106	11M06	1/4" / M6	12.70	32	40	35
1108	11M08	5/16" / M8	15.80	50	60	55
1110	11M10	3/8" / M10	15.80	50	60	55
1113	11M12	1/2" / M12	22.00	65	80	70

**MACLOC ANCHOR**

**13.16 MATERIAL SPECIFICATIONS**

CODE	Size	Expansion Shell	Expansion Cone
11	Imperial	460	580
12	Metric	460	580

**13.17 TECHNICAL PERFORMANCE**

CODE	Size	Advisory SWL Tension Min. 15N/mm Base (mm)	Advisory SWL Shear Min. 15N/mm Base (mm)	Min. Edge Distance (mm)	Min. Anchor Spacing (mm)	Min. Structural Depth (mm)
1106/11M06	12.70	2.60	1.30	105	120	75
1108/ 11M08	15.80	6.20	2.40	160	190	100
1110/ 11M10	15.80	6.20	2.40	160	190	100
1113/ 11M12	22.00	9.20	5.50	200	230	150

**13.18 SIMPLE LOAD CHARACTERISTICS**

CODE	Anchor Size	Drill Diameter (")	Anchor Length (mm)	Working Load		Min. Anchor Spacing (mm)	Min. Edge Distance (mm)
				Tensile (kN)	Shear (kN)		
1106/11M06	1/4" / M6	1/2	32	2.6	1.3	120	105
1108/ 11M08	5/16" / M8	5/8	50	6.2	2.4	190	160
1110/ 11M10	3/8" / M10	5/8	50	6.2	2.4	190	160
1113/ 11M12	3/4" / M12	7/8	65	9.2	5.5	230	200