

MACDRIVE ANCHOR

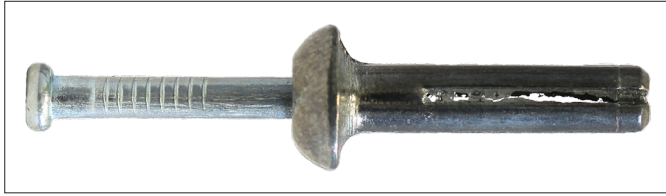

18.11 PRODUCT DATA

Material Coating:

- Zinc Alloy Plug
- Zinc Plated Nail

18.12 PRODUCT DESCRIPTION

The Macsim Macdrive Anchor is a zinc alloy plug with zinc plated assembled nail, light duty anchor, designed to expand by driving the nail into the mushroom headed plug. It can be used in a variety of different base material including concrete, hollow block, stone etc.

18.14 APPLICATIONS

- Used for Light Duty Loads

18.13 INSTALLATION METHOD

1. Drill correct diameter hole through the component and into the base at least as deep as the overall plug length.
2. Insert the Macdrive into the hole. Hammer home nail until the head is located in the plug. Do not over hit or the plug will be damaged.

18.15 ADVANTAGES

- Tamper Resistant
- Impact Setting

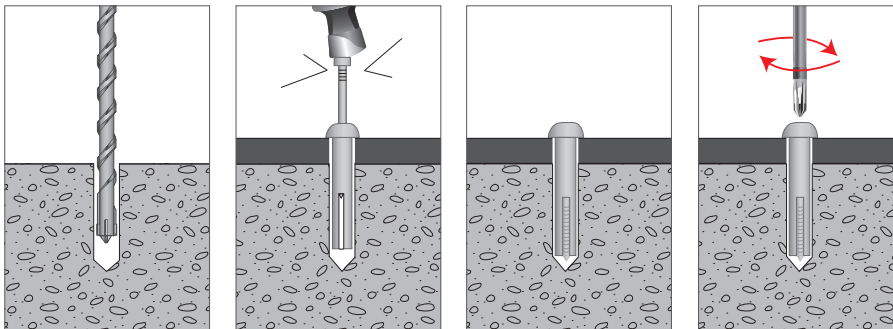

CODE	Size (mm)	Hole Diameter (mm)	Embedment Depth (mm)	Max. Fasten Thickness (mm)
1422	5 X 22	5	16	3
1425	6.5 x 25	6.5	20	5
1432	6.5 x 32	6.5	20	10
1440	6.5 x 40	6.5	20	18
1450	6.5 x 50	6.5	20	25
1475	6.5 x 75	6.5	20	50

18.16 MATERIAL SPECIFICATIONS

CODE	Size (mm)	Nail Spec.	Plug
All	All	Steel ZP	Zinc Alloy

18.17 TECHNICAL PERFORMANCE

CODE	Size (mm)	Advisory SWL Tension Min. Concrete (N)	Advisory SWL Tension Min. Brick (N)	Advisory SWL Tension Stone (N)	Advisory SWL Shear (N)
1422	5	900	n/a	n/a	900
1425-75	6.5	1100	n/a	n/a	1100